



# CRYSTAL WATER

---

Installation Guide  
CW-A1004 Slimline Reverse Osmosis System



# Contents

---

<b>SECTION</b>	<b>PAGE</b>
Features	1
Specifications	2
Water Treatment Process and Electrical Diagram	3
Product and Accessories	4
Functional Schematic Diagram	5
Installation Instructions	6
First Use Instructions	8
Cartridge Replacement	9
Troubleshooting	10
Precautions for Use	11
Commissioning Checklist	12
Warnings	13

# Features

---

- Easily Installed with the use of an Arco Conekta Mini Stop Water Diverter
- Can be easily connected to an existing Flick Mixer Tap (other fittings may be required) or the Standard Tap provided.
- Purifies Standard Municipal Water Supplies
- Automatically Shuts off Water when a Leak is Detected.
- Runs 110-240V AC Power (Power Supply included)
- Automatically Flushes system
- Built in TDS Meter
- Built in Independent Filter Monitors

# Specifications

---

## Slimline Reverse Osmosis System

- Feed Water Quality
  - Municipal Tap Water
- Voltage and Frequency
  - 100-240V, 50/60 Hz
- Power Input
  - 96 Watts
- Purified Water Flow
  - 1.2 Lt per minute
- Feed Water Temperature
  - 5-45 °C
- Feed Water TDS
  - ~250 ppm
- Feed Water Chlorine Level
  - ~0.2ppm
- Rejection:
  - 90-99%
- Feed Water Pressure
  - 100-400 kpa
- Electric Shock Resistance
  - Type II

# Water Treatment Process and Electrical Diagram

## Technological Process

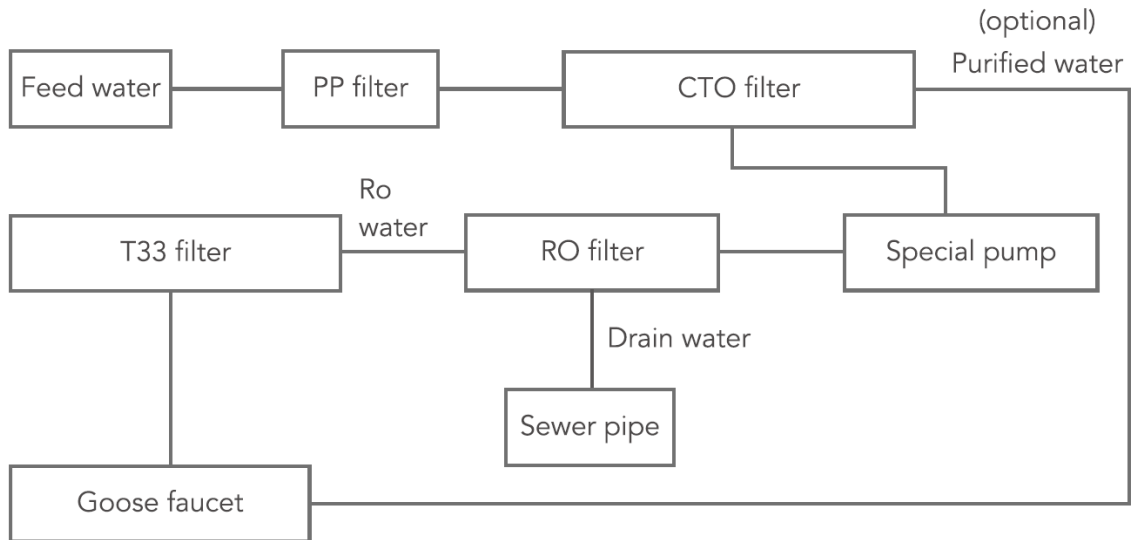

## Electrical Diagram

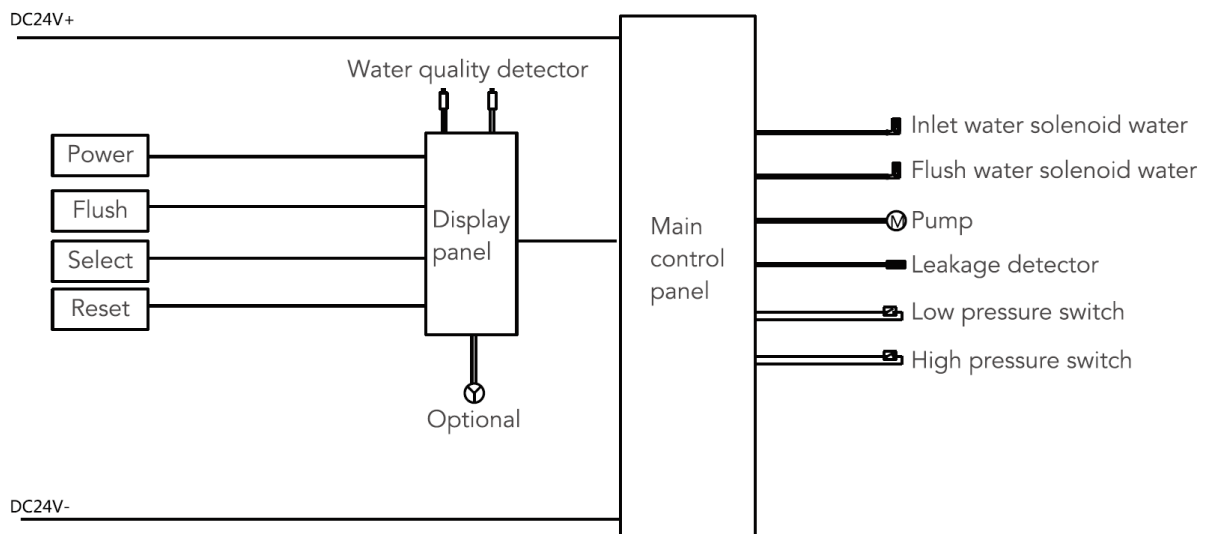

# Product and Accessories

---

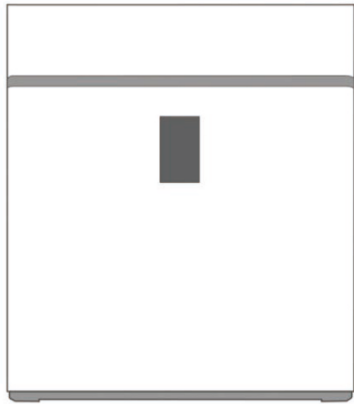

## Main Body

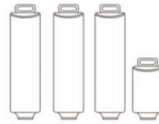

## Four Filter Cartridges

Includes spun PP filter(PP), block carbon filter(CTO), reverse osmosis membrane(RO) and post activated carbon filter(T-33).



## One Accessory Box

Includes faucet, 3-way ball valve, three pipes, instruction book, adapter and drain clamp. Reference Images for Accessories

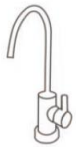

Goose faucet

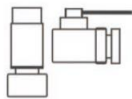

3-way ball valve



3 pipes  
(red, blue and white)



Instruction book



Adapter



Drain clamp

Note: Pictures are for reference only, subject to our available products.

# Functional Schematic Diagram

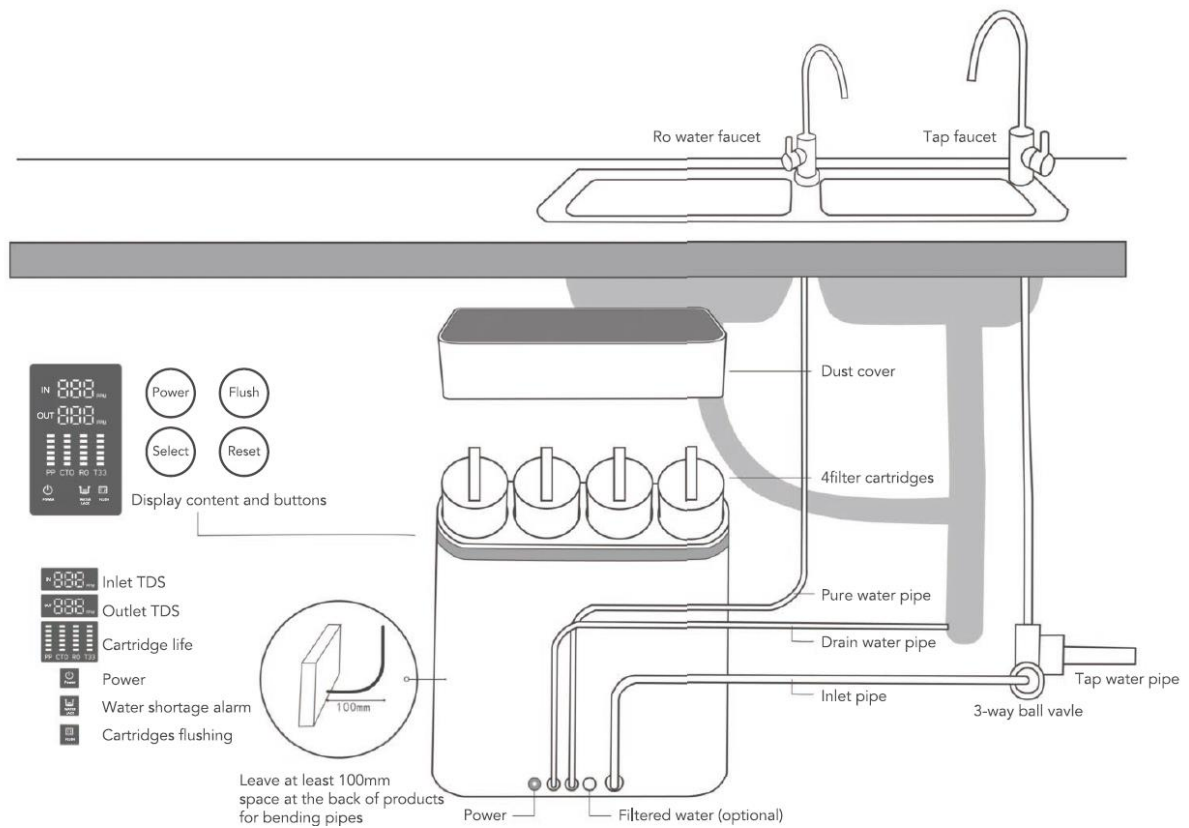

# Installation Instructions

---

## 1. Attach Inlet Water Supply

- a. Locate and Close the Cold-Water Angle Stop Valve Under your kitchen sink. Open the Cold-Water line on your existing Tap to release the water pressure.
- b. Unscrew and disconnect the braided tubing on the threaded end of the Angle Stop Valve.
- c. Attach the Solenoid Valve to the Arco Mini Stop Valve. Attach the ½" Push-fit Fitting to the End of the Stop Valve.
- d. Attach the Arco Conekta Mini Stop Valve to the existing Cold-Water Angle Stop Valve.
- e. Attach the Braided tubing to the top of the Arco Conekta Mini Stop Valve.
- f. Close the Side Valve on the Arco Conekta Mini Stop Valve and open the Cold-Water Angle Stop Valve to return water service to the Kitchen Sink. **Check for Leaks.**
- g. Measure length of tubing needed to connect the Diverted water to the Inlet of the System. Allow adequate tubing to avoid sharp turns.
- h. Cut at a 90-Degree angle using a sharp knife.
- i. Attach one end of the tubing to the Water Diverter Fitting.
- j. Measure approximately 30-50mm away from the Water Diverter Fitting along the tubing.
- k. Cut at a 90-Degree angle using a sharp knife.
- l. Attach the Water Diverter Tube to the Bottom of the PLV Check Valve and the Remaining Tube to both the outlet of the PLV Check Valve and the Inlet of the System.

## 2. Install Supplied Tap

- a. Place Cover Plate on top of the counter for the placement of the Tap.
- b. Mark on the counter for drilling the hole for the tap. Ensure there is adequate room both on top and underneath the counter/sink top for the locking nut, round plate and push fit fitting installation.
- c. Drill hole into the counter/sink top for the shaft of the Tap to go through. Clean any potential burrs or knicks around the hole.
- d. Place the small rubber Washer, Chrome Cover plate and large Rubber Washer (in that order) on the shaft of the faucet. Insert shaft into the hole on the counter/sink top.
- e. Place Round Plastic Plate and Locking Washer on under the counter/sink side of the faucet shaft. Tighten with the Locking Nut supplied on the shaft and ensure the tap handle is pointing in the desired direction.
- f. Attach the remaining Push-fit fitting onto the bottom of the shaft of the tap. Tighten to ensure the internal seal is on the base of the tap.



### 3. Attach Filtered Water to Sink Tap

Measure length of tubing needed to connect the Outlet of the Filter Head to the Tap connector fitting. Cut and insert each end of the tubing into the fittings.

### 4. Install the Drain Clamp

- a. Select a location for the drain clamp above the "S" Trap but not more than 40mm above the normal water level or the best location is on the transfer pipe between twin bowl sinks if you have one.
- b. Position the drain outlet clamp on the drainpipe. Allow adequate space for drilling. Tighten clamp with the "Tightening Screw."
- c. Using the opening in the drain outlet clamp, drill a ¼" hole in the drainpipe.
- d. Clean debris from the clamp.
- e. Attach the Red pipe, to the Drain Outlet on the System and to the Drain Clamp. Allow for adequate tubing to prevent kinks.

**NOTE: Locate the drain connection away from the garbage disposal to prevent potential contamination and system fouling.**

# First Use Instructions

---

1.
  - a. Connect RO System with the Power Adapter.
  - b. Connect to power outlet in your wall.
  - c. Check the power light indicator on the power supply is illuminated.
  - d. Once the system is powered on, a buzzer will ring **3 TIMES**.
  - e. Machine will flush for 90 seconds and the flushing icon on the system will flash.
2. The RO System will begin to make water and the on-board computer will show the real time TDS of both the incoming and outgoing of the Purified water, Cartridge Life Span, and the power indicator light. All icons will turn off when system is not in use.
3. The water storage icon will flash, and the buzzer will ring **10 TIMES** if there is insufficient or low water pressure. The System will flush for 5 seconds after having enough water or water pressure.
4. The System will stop purifying water, will flash all the icons, the buzzer will ring **30 TIMES** after 6 hours of continuous operation or if a leak has been detected.

**NOTE: Under normal operation, please draw off water for 10-15 minutes to flush cartridges when it is first used.**

# Cartridge Replacement

## Cartridge reminder

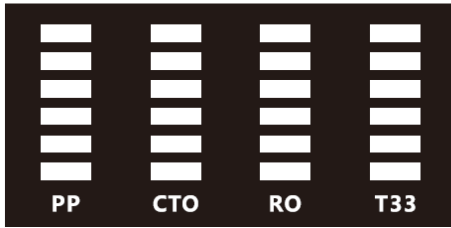

There are 6 cubes to show the current lifespan of corresponding cartridge filter. All cubes extinguish when filter's lifespan is over.

Note:

1. Actual lifespan of filters can be influenced by areas, water quality, seasons and daily water consumption, so the period of filters replacement may vary.
2. Please replace regularly.

## Recommended Replacement Period for Cartridges

STAGES	FILTER CARTRIDGE	FUNCTION	LIFESPAN (FOR REFERENCE ONLY)
The first stage	Spun PP filter	Removes larger suspended particles in water	3-6 months
The second stage	Block carbon filter	Further removes organics, chlorine, odor and turbidity	3-6 months
The third stage	RO membrane	Removes bacteria, heavy metals, dissolved matters and salinity	12-24 months
The fourth stage	Post Carbon filter	Adjusts the taste of purified water	3-6 months

## Cartridges Reset

Keep pressing Select button for 3 seconds to enter selection mode, then press Select to select the cartridge which needs to be replaced and then press Reset button. The cube shows full again. The selection mode will exit automatically if there is no operation in 5 seconds.

Please cut off the water and turn off the power before replacing cartridges.

1. Open the cap.
2. Hold the cartridge handle and rotate 90°counterclockwise, then pull it out.

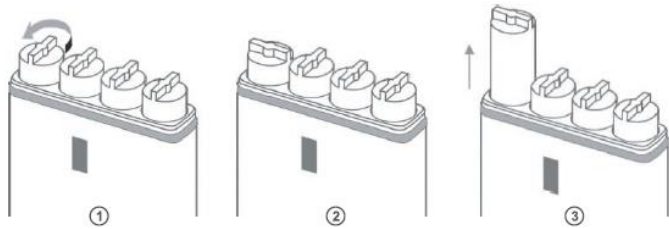

3. Replace it with new cartridge and align the arrow label to " " and rotate 90°clockwise to " ".

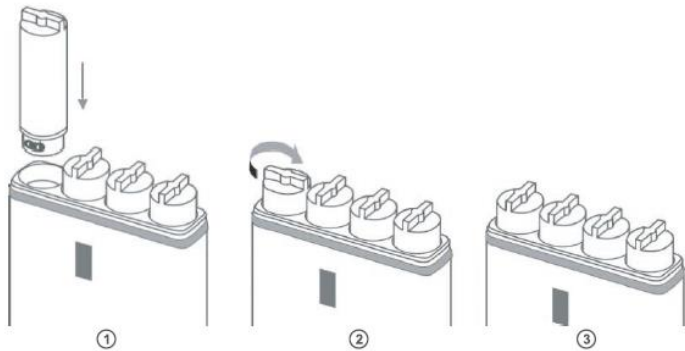

4. Cover the cap after finishing replacement.( The cap is unable to cover when cartridges are not in right place.)

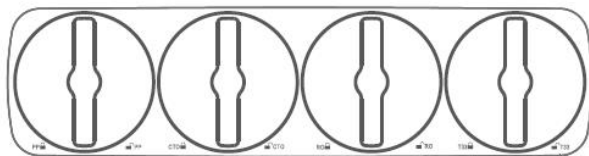

Note: Please reset cartridges after replacement.

# Troubleshooting

---

<b>Trouble</b>	<b>Cause</b>	<b>Solution</b>
Water pump is out of service and the system does not work	Insufficient feed water pressure	Increase feed water pressure
	No power or power failure	Power on
	High pressure switch is out of order	Replace High Pressure Switch
	Pump is block and power adapter fuse is burned out	Replace Power adapter and repair water pump
High TDS Value	TDS of feed water is too high, or system has not been used for a long period of time	Open the tap to draw water off the purified water for 10-15 minutes
	Cartridge lifespan is over	Replace cartridge
Water pump works but system does not work	RO membrane is Blocked	Replace RO Membrane
	Water Pump pressure loss	Repair water pump
	Flush Solenoid valve is damaged	Replace flush Solenoid Valve
Constantly running water in downtime	Inlet water solenoid valve damaged	Replace fee water Solenoid Valve
Cannot stop working when a pressure tank is full or repetitive starting	High pressure switch is damaged	Repair or replace High Pressure Switch
	Check valve is Damaged	Replace Check Valve

# Precautions for Use

---

## **ATTENTION**

1. Flush and replace cartridge regularly.
2. Do not disassemble parts randomly as it may cause leakage or damage.
3. Do not use power supply with unsupported voltage.
4. Please disconnect power and turn off Main feed water Valve if the system will not be used for long periods of time.
5. Do not store or explore in an environment of 0 °C or below.
6. Handle with care when discharging, moving, and installing.

## **REMINDER**

1. If any "Water Hammering" occurs on the system, Crystal Water will NOT take responsibility or consequences regarding any damage of malfunctions caused.
2. Please disconnect power and turn off water to the system at once in case troubles occur and ask professional staff to repair.
3. Professional staff are advised to replace cartridges only. For any other faults, a Technician may be required, or postage of the system may be required for repair.
4. It is normal to hear vibrations when the system is producing water.

# Commissioning Checklist

---

- Water Diverter Installed onto Cold Line Water Supply.
- In-line PLV Check Valve Installed before Filtration System.
- Drain clamp is secured and fitted correctly.
- Locking clips are installed on Push-Fit connections.
- Inlet and outlet connections are properly fitted and well secured (if applicable)
- Tap Fitting Installed onto Threading
- Water has been run for at least 10 to 15 minutes before use.

If any difficulties arise contact Crystal Water: Phone [+61 8 6244 1300](tel:+61862441300).

**For information on our Filtration and Service Contracts please contact Crystal Water Customer Service on [+61 8 6244 1300](tel:+61862441300) or [service@crystalwaterperth.com.au](mailto:service@crystalwaterperth.com.au).**

# Warnings

---

**For continued safety of this appliance it must be installed, operated and maintained in accordance with the manufacturer's instructions. For correct operation of this appliance, it is essential to observe the instructions as outlined in this booklet.**

- Your unit should be installed by a suitably qualified tradesperson.
- For correct operation of this unit it is essential to observe the instructions as outlined in this booklet.
- Do not use this unit with water that is microbiologically unsafe or with water of unknown quality without adequate disinfection before or after the system. Systems certified for cyst reduction may be used on disinfected water that may contain filterable cysts.
- Use this unit only as directed in these instructions and relevant Crystal Water User Guides and only for its designed purpose.
- Do not install unit if power cord is damaged.
- This unit is not intended for use by persons (including children) with reduced physical, sensory or mental capabilities, or lack of experience and knowledge, unless they have been given supervision or instruction concerning use of the appliance by a person responsible for their safety. Children should be supervised to ensure that they do not play with the unit.
- This unit is designed for indoor installation only and must not be exposed to direct sunlight, rain and excessive heat, cold, damp or dust.
- Do not store solvents or corrosive chemicals or other flammable items on or around this Unit.
- Any service or unit repairs must be performed by a trained and suitably qualified Technician.
- If the supply cord is damaged, it must be replaced by the manufacturer, its service agent or similarly qualified persons in order to avoid a hazard.
- Packaging material including plastic bags must be kept out of reach of children and disposed of according to local regulations.



---

**Crystal Water**  
236 Fletcher Road, Karnup  
Western Australia 6176, Australia

Telephone: +61 8 6244 1300  
Email: [service@crystalwaterperth.com.au](mailto:service@crystalwaterperth.com.au)

[Crystalwaterperth.com.au](http://Crystalwaterperth.com.au)

As Crystal Water has a policy of continual improvement, all details are subject to change without notice. All goods are sold subject to our published terms and conditions.